

# T5 5" Touch On-Camera Monitor

- 1920x1080 Resolution
- TOUCH
- HDMI 2.0 4K 60Hz
- HDR 3D-LUT



Touch On-Camera Monitor with Full HD Resolution, excellent color space  
Perfect gear on DSLR for taking photos & making movies.



## HDMI 2.0

**4K 60Hz - HDMI 2.0**  
HDMI 2.0 supports 4096x2160 60p/50p/30p/25p and 3840x2160 60p/50p/30p/25p.  
Some commercially DSLR(GH-5, R5...) have been upgraded to HDMI 4K 60Hz video output. It means this touch monitor is compatible with the best output video formats of DSLR on the market.

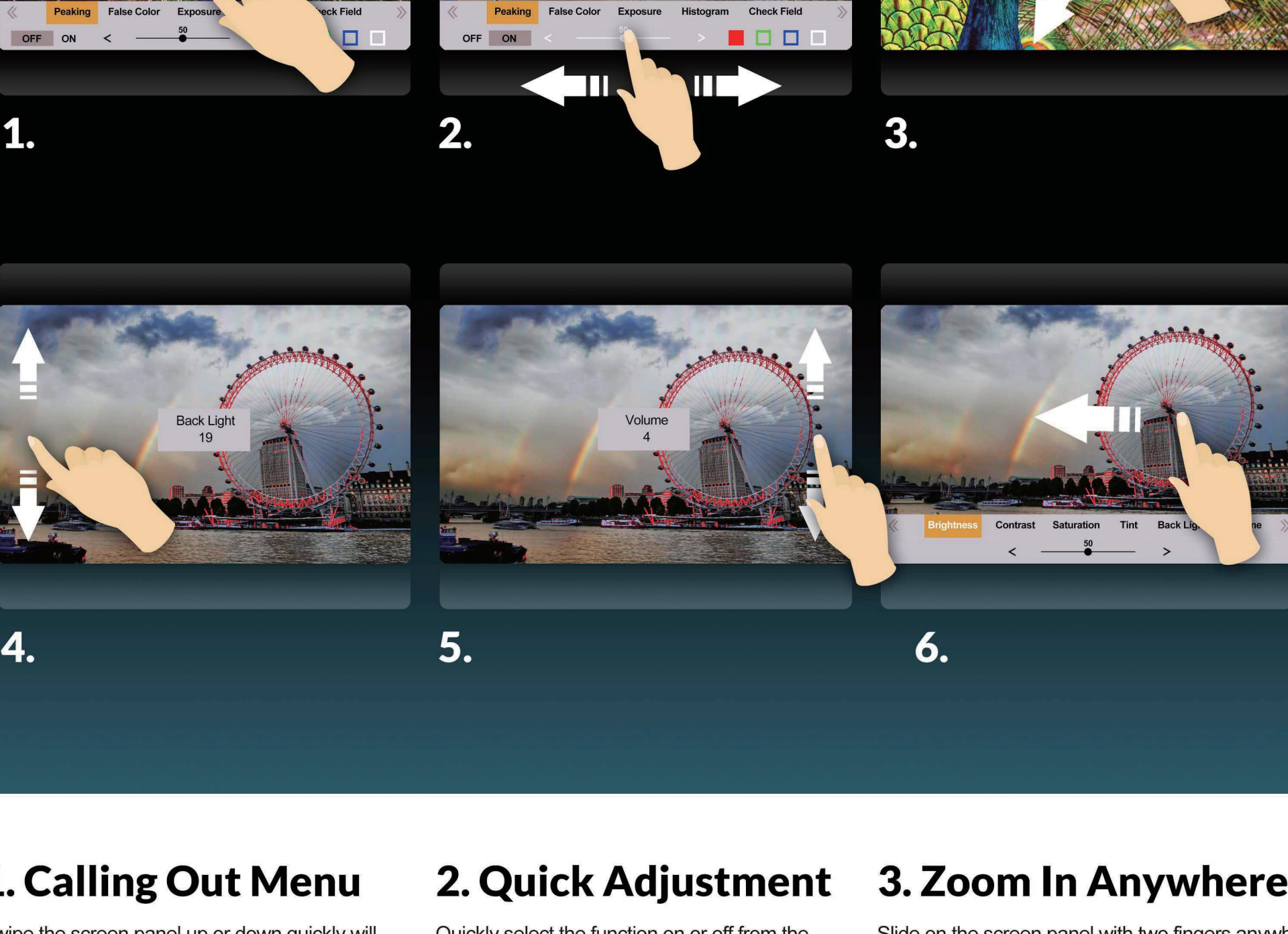

- 1. Calling Out Menu**  
Swipe the screen panel up or down quickly will summon the menu. Then repeat action to close the menu.
- 2. Quick Adjustment**  
Quickly select the function on or off from the menu, or slide freely to adjust the value.
- 3. Zoom In Anywhere**  
Slide on the screen panel with two fingers anywhere to enlarge the image, and easy drag it to any position.
- 4. Back Light Control**  
Swipe up and down on the left side of the screen to adjust the backlight.
- 5. Volume Control**  
Swipe up and down on the right side of the screen to adjust the volume.
- 6. Display Menu**  
Slide the screen left or right to quickly adjust the display parameters.

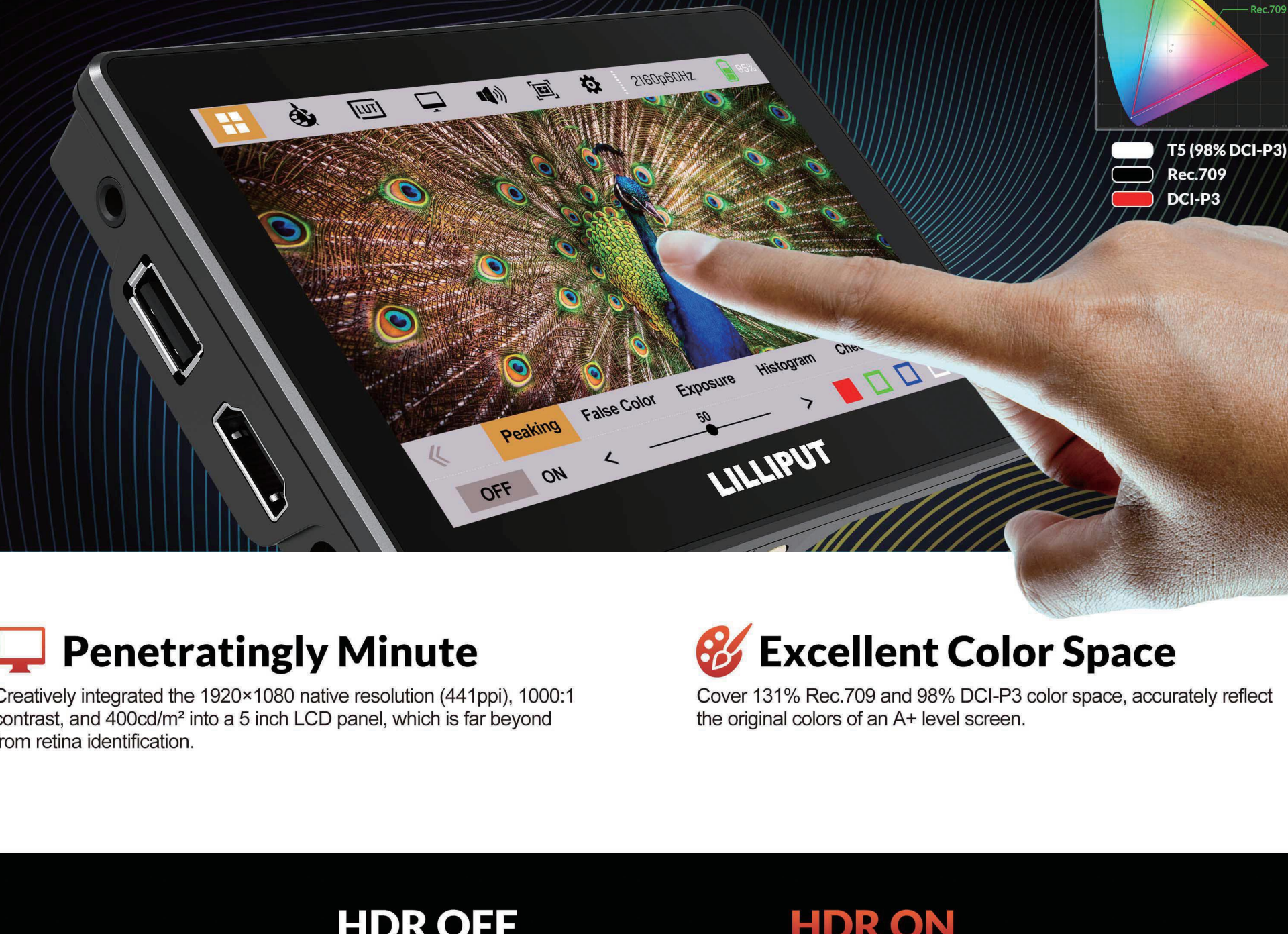

- Penetratingly Minute**  
Creatively integrated the 1920x1080 native resolution (441ppi), 1000:1 contrast, and 400cd/m<sup>2</sup> into a 5 inch LCD panel, which is far beyond from retina identification.
- Excellent Color Space**  
Cover 131% Rec.709 and 98% DCI-P3 color space, accurately reflect the original colors of an A+ level screen.



## HDR

When HDR is activated, the display reproduces a greater dynamic range of luminosity, allowing lighter and darker details to be displayed more clearly. Effectively enhancing the overall picture quality.  
Support ST 2084 300 / ST 2084 1000 / ST2084 10000 / HLG.

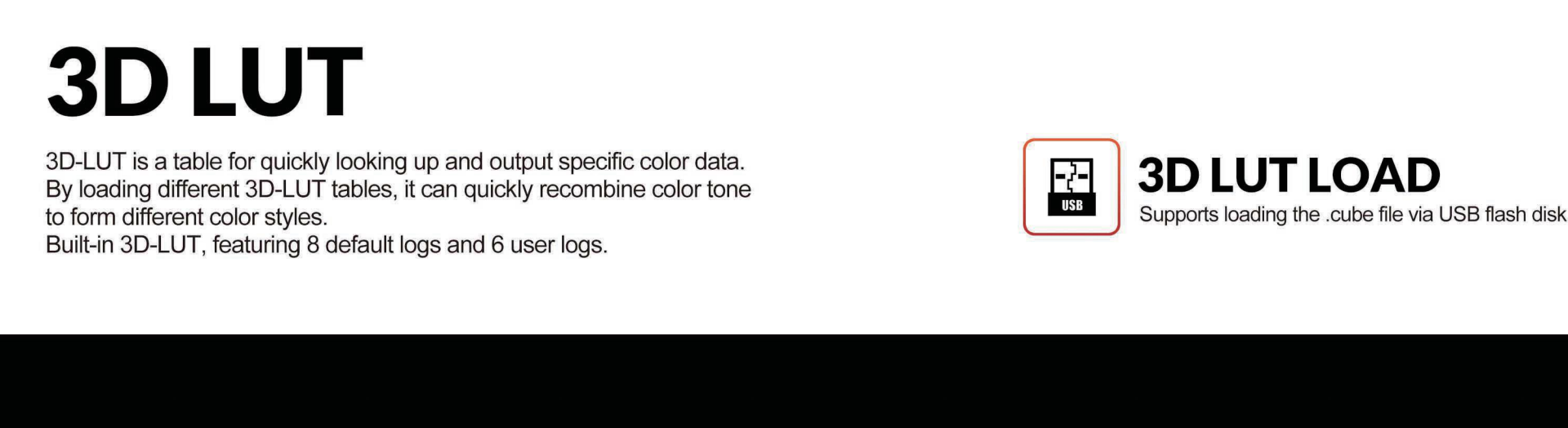

## 3D LUT

3D-LUT is a table for quickly looking up and output specific color data. By loading different 3D-LUT tables, it can quickly recombine color tone to form different color styles.  
Built-in 3D-LUT, featuring 8 default logs and 6 user logs.

**3D LUT LOAD**  
Supports loading the .cube file via USB flash disk.

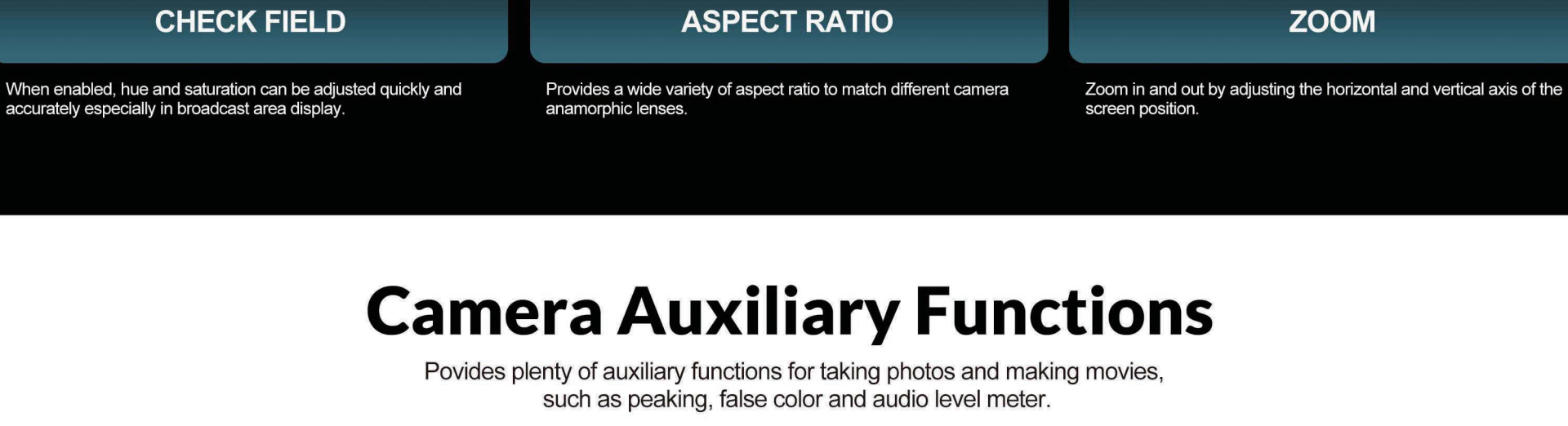
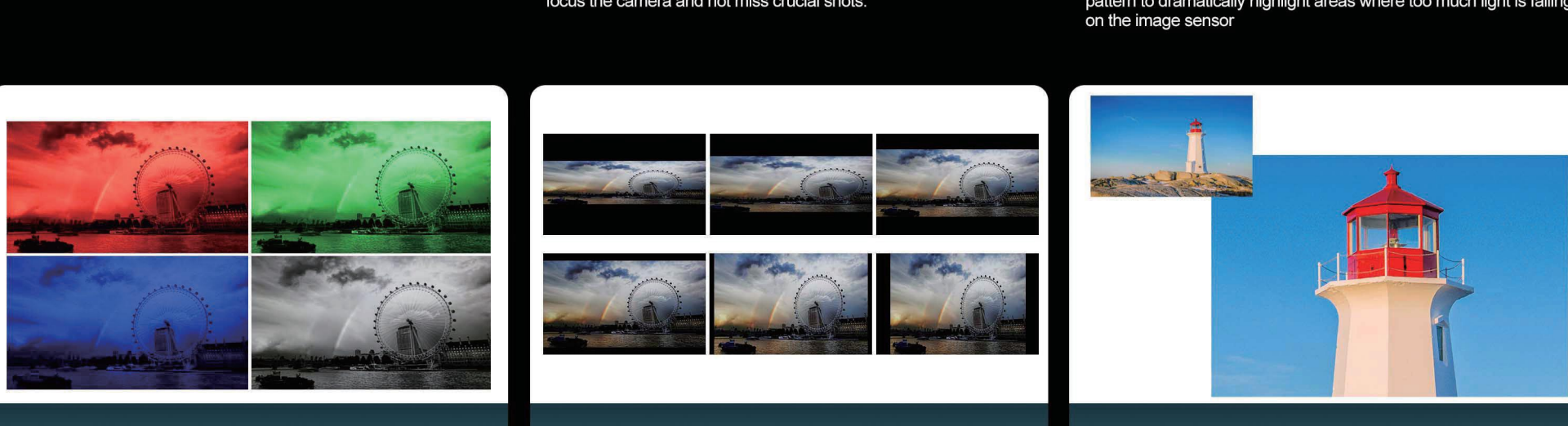
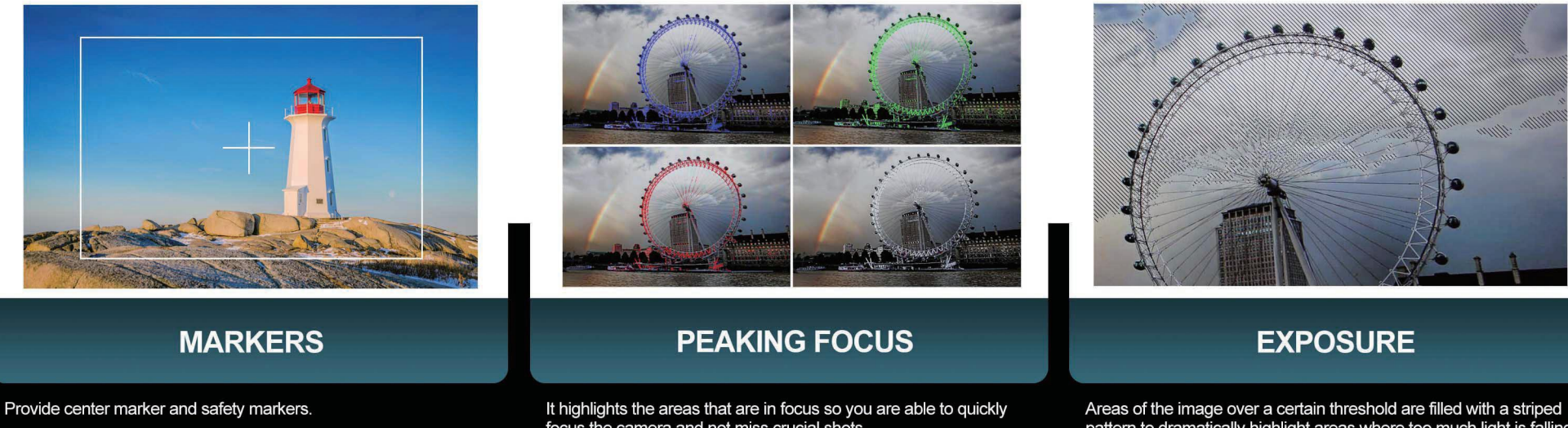

## Camera Auxiliary Functions

Provides plenty of auxiliary functions for taking photos and making movies, such as peaking, false color and auto level meter.

- 3D LUT
- HDR
- Peaking
- Level meter
- LUT support
- False color
- Histogram
- HV Delay
- Exposure
- Check field
- Image flip
- Pin-to-pin
- Marker
- Freeze



## Versatile Battery Structure

A dual battery mounting plate on the back is compatible with both Canon LP-E6 and Sony F-series batteries, and the DC 8V power output is also useful for unlimited purposes.



## SPECIFICATIONS

|                                       |  |  |
|---------------------------------------|--|--|
| <b>DISPLAY</b>                        | Panel: Touch Screen<br>Physical Resolution: 1920x1080<br>Aspect Ratio: 16:9<br>Brightness: 400cd/m <sup>2</sup><br>Contrast: 1000:1<br>Viewing Angle: 170°/ 170°(H/V)<br>HDR: ST 2084 300/1000/10000 / HLG | 5" IPS<br>Capacitive<br>1920x1080<br>16:9<br>400cd/m <sup>2</sup><br>1000:1<br>170°/ 170°(H/V)<br>ST 2084 300/1000/10000 / HLG |
| <b>VIDEO INPUT SUPPORTED FORMATS</b>  | LUT support: Sony Slog / Slog2 / Slog3 or User...<br>HDMI: 1xHDMI2.0<br>HDMI: 2160p 24/25/30/50/60, 1080p 24/25/30/50/60, 1080i 50/60, 720p 50/60...   | 1xHDMI2.0<br>2160p 24/25/30/50/60, 1080p 24/25/30/50/60, 1080i 50/60, 720p 50/60...  |
| <b>AUDIO IN/OUT (48kHz PCM Audio)</b> | HDMI: 3.5mm - 2ch 48kHz 24-bit<br>Ear Jack: 3.5mm - 2ch 48kHz 24-bit   | 3.5mm - 2ch 48kHz 24-bit<br>3.5mm - 2ch 48kHz 24-bit   |
| <b>POWER</b>                          | Input Voltage: DC 7-24V<br>Power Consumption: ≤5W / ≤17W (DC 8V power output in operation)<br>Compatible Batteries: Canon LP-E6 & Sony F-series  | DC 7-24V<br>≤5W / ≤17W (DC 8V power output in operation)<br>Canon LP-E6 & Sony F-series  |
| <b>ENVIRONMENT</b>                    | Power Output: DC 8V<br>Operating Temperature: 0°C-50°C<br>Storage Temperature: -10°C-60°C  | DC 8V<br>0°C-50°C<br>-10°C-60°C  |
| <b>OTHER</b>                          | Dimension(LWD): 132x86x18.5mm<br>Weight: 200g  | 132x86x18.5mm<br>200g  |

## ACCESSORIES

